

---

**TOP ONE TECH LIMITED**  
**27" LCD Open frame Touch Monitor**  
(The Dust-proof,PCAP ,LED backlight)

Model: TOT270UCA001

Part number:TOT270K1C001



Top One Tech's 27" open frame LCD touch monitors have a long-lasting product cycle because the enclosure is controlled by Top One Tech's specifications. Future panel improvements are therefore possible without external changes. The TOT270UCA001 integrate with the Top One Tech's PCAP technology touchscreen.

## Features

- Bezel seal standard: Dust-proof
- Long lasting product cycle-enclosure controlled by TOP ONE TECH specifications
- Future generation panels phased-in without external changes
- High quality panel with high brightness,high contrast ratio and broad viewing angle
- Multiple mounting options including VESA mount, horizontal or vertical bracket-mount
- Compact and slim profile for easy integration from side,top and bottom
- TOP ONE TECH's SAW technology on pure glass for the ultimate in image quality
- Finger or gloved hand operation
- Dual USB/Serial touch interface port
- Dual VGA/DVI input video format
- Worldwide agency approvals

## Specification

<b>Model No.</b>	TOT270UCA001	
<b>Series</b>	OT	
<b>LCD Type</b>	TFT-LCD	
<b>Display Size</b>	27 " ( diagonal )	
<b>Display Mode</b>	VA Mode, Normally Black	
<b>Active Area</b>	600 mm×338mm	
<b>Suggested Resolution</b>	1920×1080	
<b>Support Colors</b>	16.7M	
<b>Brightness(Typ.)</b>	270cd/m <sup>2</sup>	
<b>Response Time(Typ.)</b>	12ms	
<b>Viewing Angle (Typ.at CR&gt;10)</b>	Horizontal(left/right)	85°/85°
	Vertical(up/down)	80°/80°
<b>Contrast Ratio(Typ.)</b>	1000:1	
<b>Video Input</b>	VGA\DVI	
<b>Frequency (H/V)</b>	30~80KHz / 60~75Hz	
<b>Power Supply</b>	Type: External brick	
	Input (line) voltage: 100-240 VAC, 50-60 Hz	
	Output voltage/current: 12 volts at 5 amps max	
<b>Environment</b>	Operating Temp.	0~50°C
	Storage Temp.	-20~60°C
	Operating RH:	20%~80%

	Storage RH:	10%~90%
<b>MTBF</b>	50,000 Hours	
<b>LCD Back light Life(Typ.)</b>	50,000 Hours	
<b>Backlight Unit</b>	LED	
<b>Weight (N.W/G.W)</b>	9.5Kg /11.5Kg (Approx.)	
<b>Out package Dimensions</b>	825*220*575(mm)	
<b>Power Consumption</b>	40W Max.	
<b>Standby power consumption</b>	0.60W	
<b>OSD Control</b>	Buttons	AUTO,RIGHT,LEFT,MENU,POWER
	Function	Brightness, Contrast Ratio, Auto-adjust, Phase, Clock, H/V Location, Languages, Function, Reset
<b>Touch screen Type</b>	27" capacitive 5.3mm thickness of touch screen sensor	
<b>Touch System Interface</b>	USB	
<b>Certificates</b>	ETL,RoHS	

NOTE:The display SPEC. will change follow the relevant LCD panel brand and model

## Mechanical Dimensions

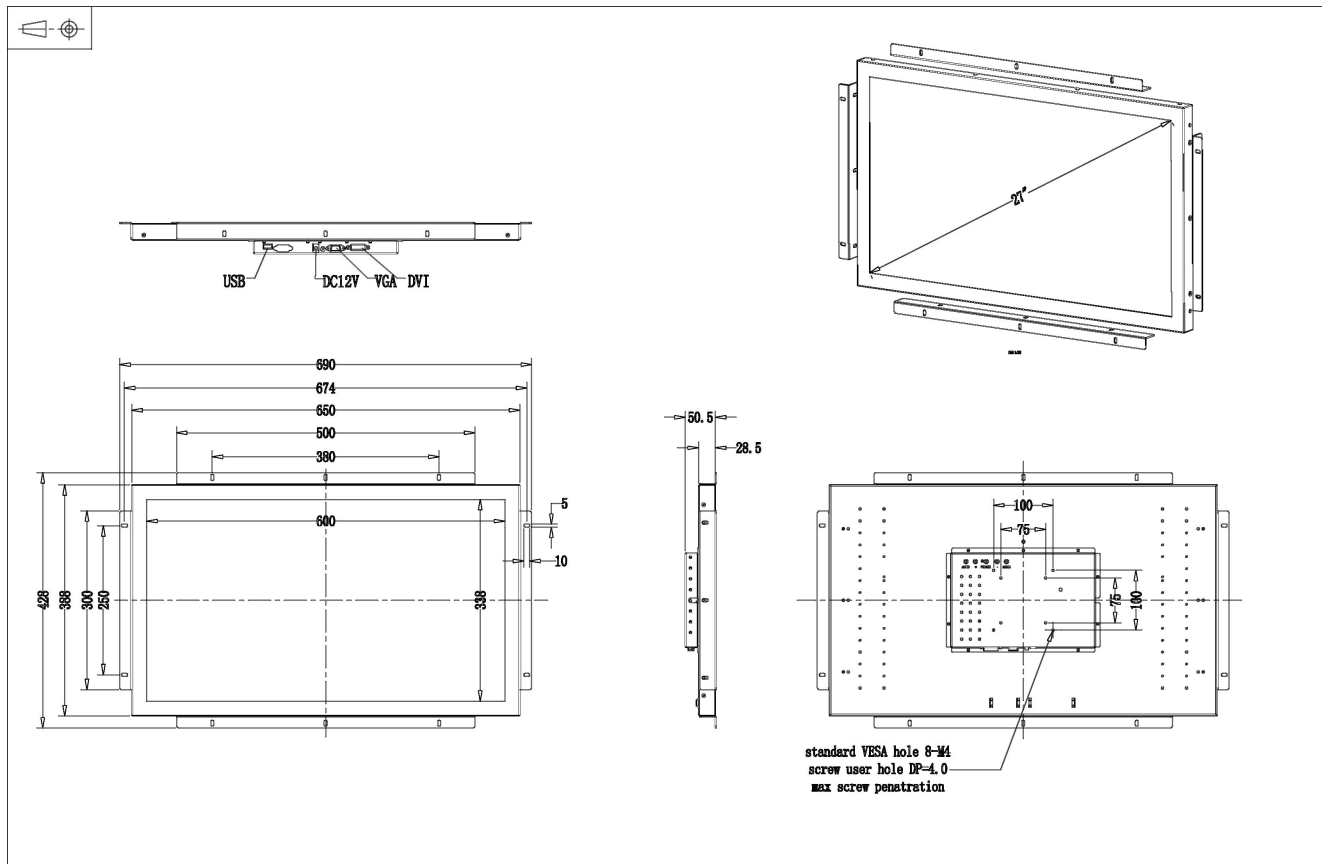

## Accessories

**Power Cable:** A North American power cable or an European power cable is included according to the end user's area.

**Power Supply Brick:** A power supply brick is included.

**Touch/Video/DVI Cables:** Detachable serial or USB touch cable , video cable and DVI cable are included

**L-brackets:** Four standard L-brackets are included.

## Typical Application

Gaming/Casino Systems  
Outdoor and indoor Kiosks  
Entertainment  
Transport and Ticketing  
Hospitality  
Banking  
Customized Solutions

## How to contact us

TOP ONE TECH LIMITED

Mobile Phone : (+86)13631610695

Tel: 0086-0755-21070641

Whatsapp/Wechat :+8613631610695

Email : sales@toponetech.cn

Skype : elsieyu-sz@hotmail.com

Office in China : Room 1517, Taiyangneng Guigu Building Zhongxing Xiaoqu, Yunfeng Road No.3  
Gaofeng shequ, Longhua District, Shenzhen, China

Facilities in China : No. 2, Guihua Jiayi Industrial district, Guanlan, Longhua, Shenzhen, China 518109